

# STAGE 2

ADULT OFF-ROAD ELECTRIC DIRT BIKE

## STAGE 2

Certified compliant  
with UL2272 by  
Guangdong UTL Co.,  
Ltd., an accredited  
testing lab

## OWNER'S MANUAL

Read and understand this entire manual before using this product!  
For assistance contact customer service. DO NOT RETURN.



Dirt bike is to be used in OFF-ROAD AREAS ONLY. Check your local laws before riding.  
Please read manual for information on assembly and product features.

MISSION

SCAN QR CODE FOR DIGITAL  
COPY OF OWNER'S MANUAL



|                                     |       |
|-------------------------------------|-------|
| Welcome / NY Statute .....          | 2     |
| Introduction.....                   | 3     |
| Safety Warnings .....               | 4     |
| General Safety .....                | 5     |
| Assembly / Set-up.....              | 6-7   |
| Battery Installation / Removal..... | 8-9   |
| Battery Charging .....              | 10    |
| Battery Safety.....                 | 11    |
| Pre-Ride Checklist.....             | 12    |
| Riding Procedure .....              | 13    |
| Display Functions .....             | 14    |
| Troubleshooting.....                | 15-16 |
| Maintenance.....                    | 17-18 |
| Product Specifications .....        | 19-20 |
| Circuit Diagram .....               | 21    |
| Limited Warranty.....               | 22    |



Please have your product along with the 19 character product I.D. code with you before contacting customer service for warranty assistance and/or replacement parts.

Product I.D. Code: \_\_\_\_\_ - \_\_\_\_\_ - \_\_\_\_\_

# WELCOME

Images are for reference only. Please refer to actual product.

Serial number is stamped onto the headtube of the frame.  
DO NOT change or alter this number as it is a legal identifier for your Stage2 Adult Dirt Bike

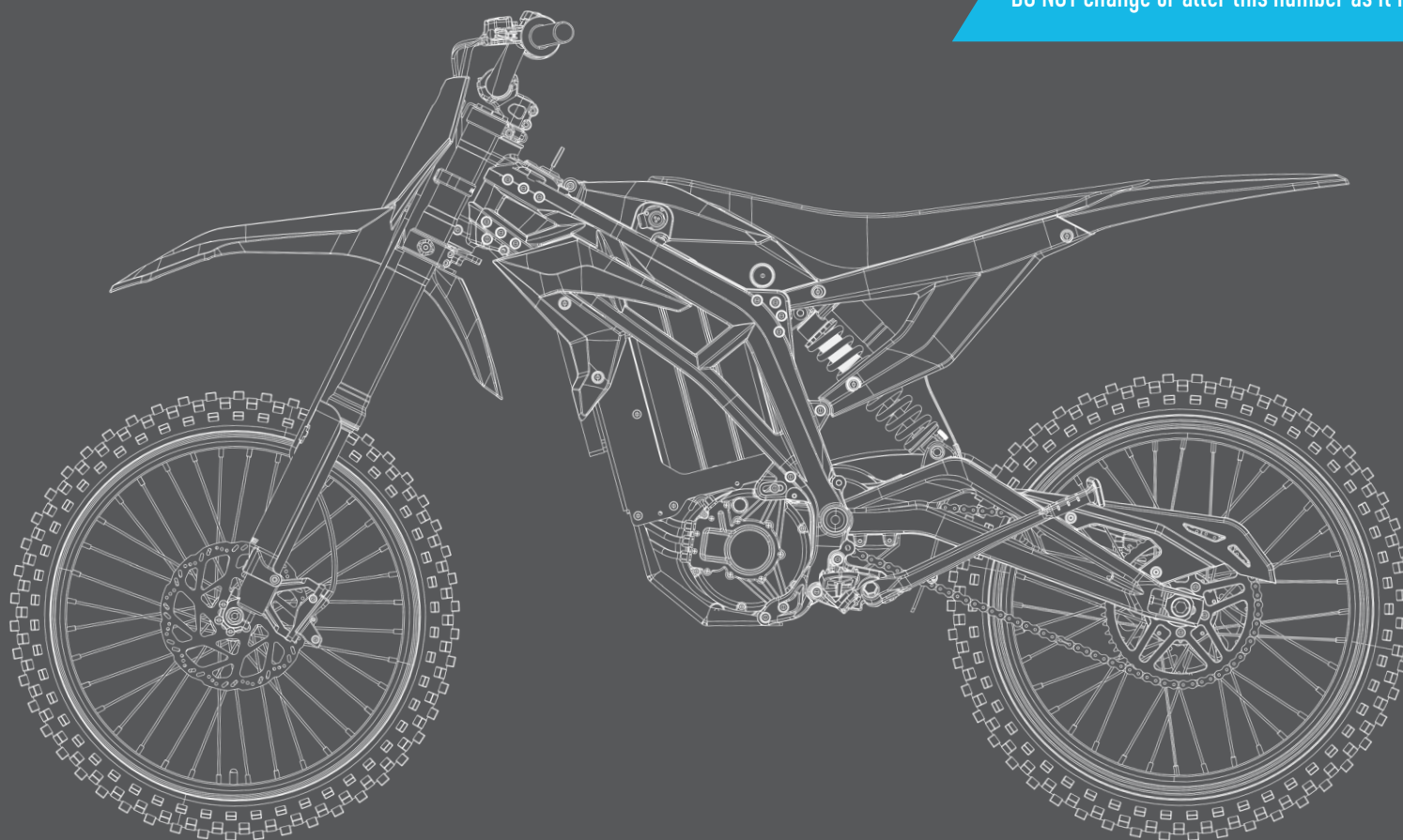

#### BOX CONTENTS:

- Electric Dirt Bike
- Accessory Box 1 - Charger
- Accessory Box 2 - Rear Shock
- Accessory Box 3 -
  - Right Fairing
  - Left Fairing
  - Front Number Plate
  - Top Clamp (with hardware)
  - Right Foot Peg
  - Swing Arm Bolt Cap
  - Owner's Manual
  - Tool Kit

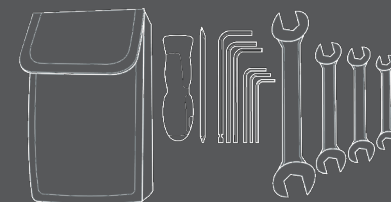

#### STAGE 2

Certified compliant  
with UL2272 by  
Guangdong UTL Co.,  
Ltd., an accredited  
testing lab

Read and understand this entire manual before using this product!  
For assistance contact Razor USA / Stage2 Customer Service at (866) 467-2967



# STAGE2

ADULT OFF-ROAD ELECTRIC DIRT BIKE

## INTRODUCTION

THE STAGE2 ELECTRIC DIRT BIKE IS FOR **ADULT USERS** AND SHOULD ONLY BE RIDDEN CAREFULLY AND RESPONSIBLY BY APPROPRIATELY MATURE AND RESPONSIBLE RIDERS EXERCISING CAUTION AND RESPECTING APPLICABLE LAWS.

This product is not a toy for young riders! This product is manufactured to be used OFF-ROAD ONLY and is not designed or intended to be street legal. Stage2 emphasizes the importance of riders to understand the risks associated with riding an electric dirt bike. Bluntly put, you could get hurt and your actions could cause injury to others. You must be cautious, alert and take reasonable precautions to minimize such risks of falls, impacts or other dangerous situations.

The user must be, and is, responsible for determining whether local laws permit use of the Stage2 in varying circumstances (there is no “uniform Federal law” in existence to establish universal riding conditions). The rider must be, and is, responsible for acting maturely, carefully and with respect for potentially adverse riding conditions including darkness or impaired visibility, fog, rain, snow, hail, ice or electrical storms, which increase the dangers inherent in operating any electric dirt bike. The rider must be, and is, responsible for adjusting riding behavior and braking distance to suit the weather and riding conditions, and also to recognize that riding in low visibility conditions decreases your ability to see and be seen. It is absolutely recommended that any rider wear a proper helmet to minimize potential head injuries.

Use of the Stage2 electric dirt bike is recommended for mature riders - using age 18+ (the generally recognized age of “legal consent”) as a guide. Riders of the Stage2 electric dirt bike must respect and adhere to all locally applicable laws and rules applicable to the use of such products, be legal and be safe!





# STAGE2

ADULT OFF-ROAD ELECTRIC DIRT BIKE

## SAFETY WARNINGS

### ⚠ WARNING

Riding presents potential risks and caution is required. When riding this electric dirt bike there are inherent hazards associated with its use (for example, falling off or riding it into a hazardous situation). Like any riding product, Stage2 is intended to move, therefore, it is possible to lose control or otherwise get into dangerous situations. Riders must recognize that if such things occur, a rider can be seriously injured or die, even when using safety equipment and other precautions. **RIDE AT YOUR OWN RISK AND USE COMMON SENSE.**

### ⚠ WARNING

Always check and obey any local laws or regulations. These may affect the locations where Stage2 electric dirt bike may be used. This bike is for off-road use only, riding on public streets may result in legal action or risk of traffic-related injuries.

### ⚠ WARNING

Stage2 electric dirt bike is for mature riders. It is only to be used in off-road conditions, or as legally permitted, personal responsibility and compliance with local laws is imperative and is the rider's responsibility. Only use where allowed and with caution.

### ⚠ WARNING

**MATURE RIDERS ONLY:** The Stage2, presents potential hazards plainly associated with its use.  
**USE YOUR BEST JUDGMENT:** Not everyone is suited to ride this product, physical and mental abilities should be considered before riding.

**ADULT USE ONLY,** children under the age of 18 should not be permitted to use this product. This recommendation is based not just on age or weight or height; it reflects consideration of expected maturity and skills as well as physical size. The recommended rider age of 18 years or older is only an estimate and can be affected by the rider's size, weight or skills - not every rider 18 years old or older will be suited to the product. Certainly, any rider unable to fit comfortably on the Stage2 electric dirt bike should not attempt to ride it.

### ⚠ WARNING

**NOT FOR RIDERS UNDER AGE 18 OR HEAVIER THAN 200 LB (90 KG). DO NOT EXCEED THE WEIGHT LIMIT OF 200 LB (90 KG)** - including backpacks and other items that might be carried. Exceeding the weight limit could injure the rider and damage the Stage2. Rider weight alone also does not necessarily mean a person's size is appropriate to fit or maintain control of the Stage2. Keep this product away from small children and remember that this product is not a toy and is intended for use only by persons who are, at a minimum, completely comfortable and competent while operating the product.

# ! SAFETY INSTRUCTIONS

**Keep this product away from small children and remember that it is intended for Adult use only by persons who are, at a minimum, completely comfortable and competent while operating the Stage2 electric dirt bike.**

Persons with any mental or physical conditions that may make them susceptible to injury, impair their physical dexterity or mental capabilities to recognize, understand, and follow safety instructions and to be able to understand the hazards inherent in the use of any ride-on product, should not use or be permitted to use products inappropriate for their abilities. Persons with heart conditions, head, back or neck ailments (or prior surgeries to these areas of the body), or pregnant women, should be cautioned not to operate the Stage2 electric dirt bike.

**DO NOT EXCEED THE WEIGHT LIMIT OF 200 lb (90 kg). Rider weight does not necessarily mean a person's size is appropriate to fit or maintain control of the Stage2.**

## CHECK AND MAINTAIN PRODUCT CONDITIONS

Before use, check to confirm that covers and guards are in place and in serviceable condition. Check that the brakes and display are functioning properly, that the tires are inflated properly and have sufficient tread remaining. The product should be maintained and repaired in accordance with the manufacturer's specifications, using only the manufacturer's authorized replacement parts, and should not be modified from the manufacturer's original design and configuration.

## ACCEPTABLE RIDING PRACTICES AND CONDITIONS

Do not activate the throttle unless you are on the Stage2 and in a safe, outdoor environment suitable for riding. Once the throttle is activated the Stage2 will move forward.

The normal powered top speed of this product will be approximately 47 mph (75.6 km/h), which can be affected by conditions, such as rider weight, inclines and battery charge level. Avoid excessive speeds that can be associated with downhill rides.

Maintain a hold on the handlebars at all times. Do not touch the brake rotors or motor on your Stage2 when in use or immediately after riding, as these parts can become very hot.

Ride defensively. Watch out for potential obstacles that could catch your wheel or force you to swerve suddenly or lose control. Be careful to avoid anything that may enter your path, and respect the rights and property of others.

The Stage2 is intended for use on off-road surfaces, such as loose debris, sand, leaves, rocks or gravel. Wet, slick, bumpy, uneven or rough surfaces may impair traction and contribute to possible accidents. Do not ride your product on ice, puddles or water. Watch out for potential obstacles that could catch your wheel or force you to swerve suddenly or lose control. Avoid sharp bumps, asphalt/roads and sudden surface changes.

Use caution when attempting stunts or tricks on the Stage2. The Stage2 is not made to withstand abuse from misuse, such as aggressive jumping, curb grinding or any other type of stunts. Racing, stunt riding, or other maneuvers also enhance risk of loss of control, or may cause uncontrolled rider actions or reactions.

# GENERAL SAFETY

Riding at night or when visibility is limited increases risks of accident or injury. Should the Stage2 be ridden in such conditions, use of lights and additional measures to increase rider visibility and Stage2 conspicuity are advised.

Single Rider: This product is designed for one person only. Do not carry passengers or other items. Never allow more than one person at a time to ride the product.

Never use near steps or swimming pools.

The Stage2 can operate more quietly than other motorized products may operate. Use care when in the vicinity of pedestrians or others who may have difficulty hearing your approach.

Do not allow hands, feet, hair, body parts, clothing, or similar articles to come in contact with moving parts or wheels while the motor is engaged.

Do not touch electric motor or brake rotors when in use or immediately after riding.

Never use headphones or a cell phone to talk or text when riding.

**Never ride your product while under the influence of drugs or alcohol.**

## PROPER RIDING ATTIRE

Always wear proper protective equipment, such as an approved safety helmet (with chin strap securely buckled), elbow pads, and kneepads. A helmet may be legally required by local law or regulation in your area. A long-sleeved shirt, and long pants are recommended. Always wear shoes and keep shoelaces tied and out of the way of the wheels and motor. Never ride barefooted or in sandals.

## ! WARNING

**When using this product, basic precautions should always be followed, including the following:**

- Read all the instructions before using product.
- Do not put fingers or hands into the product.
- Do not use this product if any wiring or electrical system shows signs of wear or damage.



# STAGE 2

ADULT OFF-ROAD ELECTRIC DIRT BIKE

## ASSEMBLY / SET-UP

! All required tools come with the product and can be found in the tool kit



### Attaching the Handlebar

Required tool: 6 mm Allen Wrench

**Step 1:** Remove the handlebar and position in the middle of the lower handlebar clamp on the fork.

**Step 2:** Once the bar is properly positioned, take the upper clamp and attach it to the top, once all four screws are aligned, tighten until the handlebar no longer moves forward or backwards.

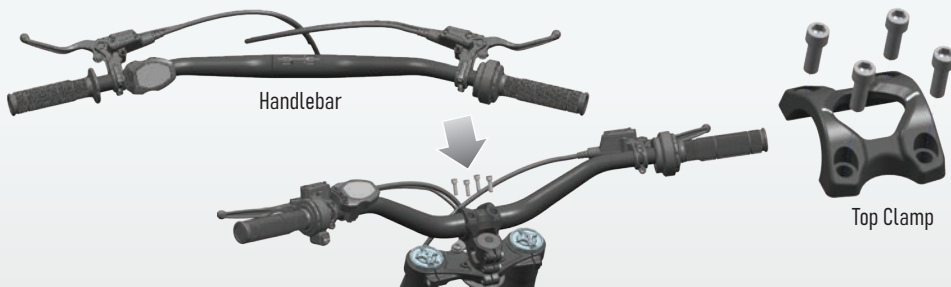

### Rear Shock Assembly

Required tools: 5 mm Allen Wrench and 10 mm Allen Wrench

**Step 1:** Remove the temporary bar that is in the rear shock assembly mount.

**Step 2:** Align the rear shock in its mounting place. Make sure the top and bottom eyelet holes align. **Note: Reservoir cylinder should be at the top.**

**Step 3:** Insert the two mounting bolts into the top and bottom eyelets and secure each bolt in place with the backing nut. Tighten the bolts until there is no movement in the shock assembly.

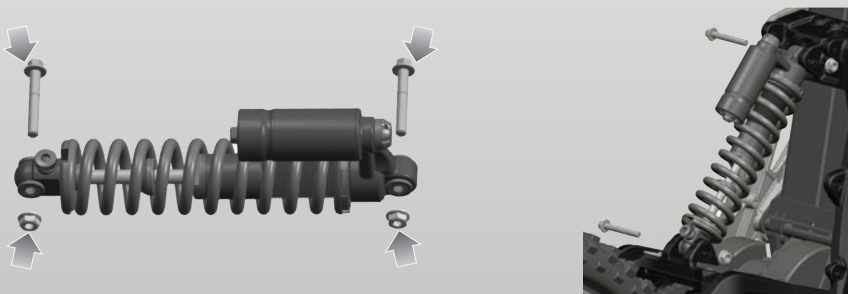

### Attaching the Front Fender

Required tool: 4 mm Allen Wrench

**Step 1:** Position the front fender in between the fork legs.

**Step 2:** Once the fender is in position, insert the three washers and screws (washers first). Tighten the screws until the fender is secure. Do not over tighten.

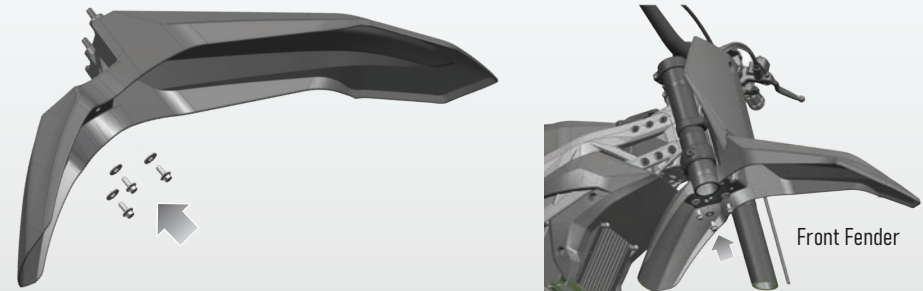

### Attaching the Front Number Plate

Required tool: 6 mm Allen Wrench

**Step 1:** Position the front number plate above the front fender on the fork.

**Step 2:** Once the number plate is in position, insert the single washer and screw (washers first). Tighten the screw until the number plate is secure. Do not over tighten.



# STAGE 2

ADULT OFF-ROAD ELECTRIC DIRT BIKE

## ASSEMBLY / SET-UP

 All required tools come with the product and can be found in the tool kit



### Attaching the Front Wheel

Required tool: 6 mm Allen Wrench

**Step 1:** Align the wheel in the wheel mount so that the brake rotor is on the side of the caliper mounting bracket.

**Step 2:** Once the wheel is in place, insert the axle rod and the two bolts on either side.

**Step 3:** Insert the two bottom bolts (right and left side) to lock the bottom cap in place.

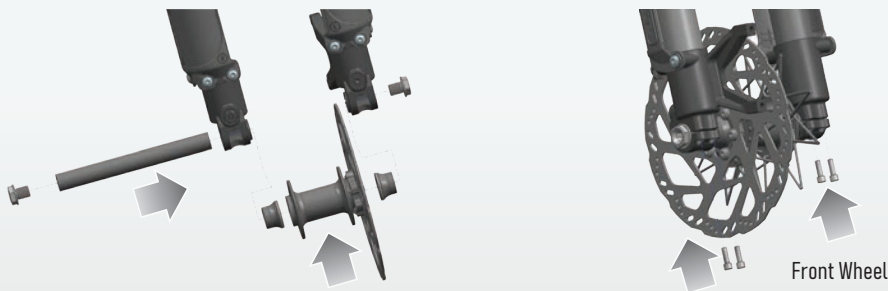

### Attaching the Front Brake

Required tools: 5 mm Allen Wrench and 10 mm Allen Wrench

**Step 1:** Remove the temporary shipping spacer from the caliper, then align the front brake caliper on the brake mount, the caliper should sit between each side of the rotor.

**Step 2:** Insert the two mounting screws into the top and bottom eyelets and secure each screw in place. Tighten the screws until the caliper is secure.

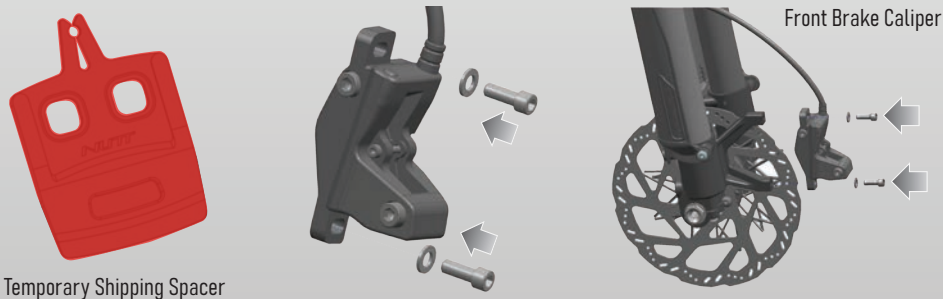

Temporary Shipping Spacer



### Attaching the Right and Left Fairings

Required tool: 6 mm Allen Wrench

**Step 1:** Position the fairing on the left/right side of the bike (make sure they are on correct side).

**Step 2:** Once the fairing is in position, insert the two washers and screws (washers first). Tighten the screws until snug. Do not over tighten.

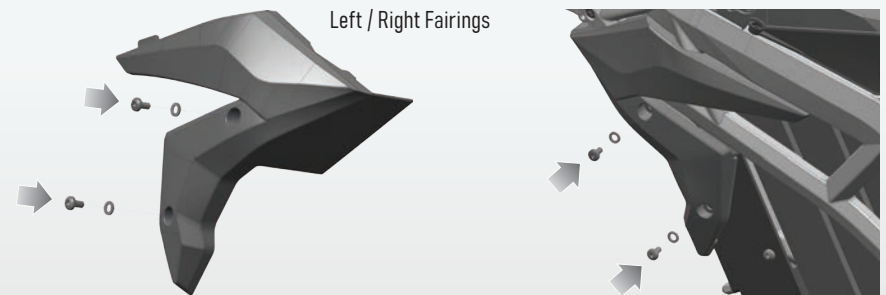

### Attaching the Foot Pegs

Required tool: 6 mm Allen Wrench

**Step 1:** Position both foot pegs on either side of the bike, and align the eyelets.

**Step 2:** Once the foot pegs are in position insert the two screws. Tighten the screw until the pegs are secured in place.

**Step 3:** Install the swing arm bolt cap by pressing / securing it into the hole in the frame above the foot peg.

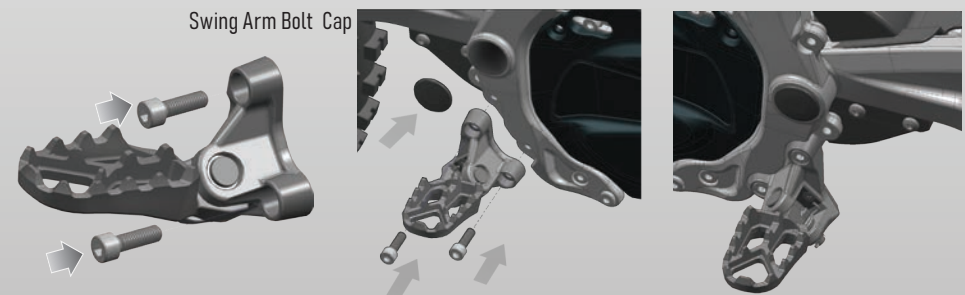



! Always make sure the bike is switched to the "OFF" position before removing or installing the battery. Not doing so can cause personal injury or damage to the battery.

# BATTERY INSTALLATION / REMOVAL

## BATTERY INSTALLATION / REMOVAL

1. Remove the wingnut that is located under the rear-most part of the seat. Once the wingnut is removed, the seat can be taken off.
2. Seat can be removed by first pulling up on the back of the seat. After lifting, slide the seat towards the rear of the bike.
3. Insert the key into the battery cover lock push in, and turn it clockwise. There will be a positive click at the end of the rotation.
4. Remove the plastic battery cover.
5. Look for the red fuse switch located in front of the battery. The red switch needs to be flipped off when installing / removing the battery.  
**NOTE: When ready to use bike, turn the fuse switch back to the "ON" position.**
6. Unplug the power connector from the top of the battery by pressing the tab on the front of the connector and pulling up.
7. Once the connector is removed and the fuse switch is off, remove the battery by pulling straight up on the attached handle.

! Repeat these steps in reverse order when installing the battery.

### ! WARNING

When bike is being stored for long periods of time, the fuse switch should be switched to the "off" position.

### ! WARNING

DO NOT Install or remove the battery without first consulting this section of the manual. If steps are done out of order, the battery or bike components can be damaged.

STEP 1: REMOVE WINGNUT UNDER SEAT

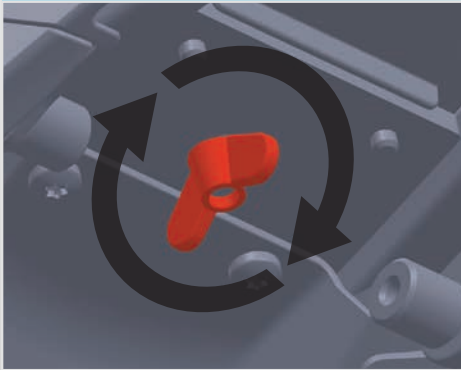

STEP 2: REMOVE SEAT

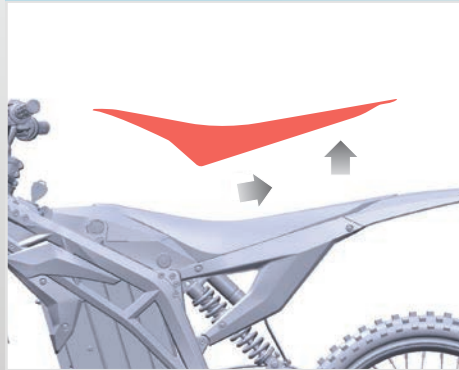

STEP 3: UNLOCK BATTERY COVER

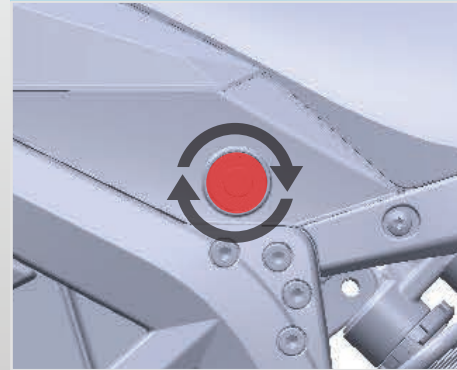

Push in and turn the key to unlock

STEP 4: REMOVE BATTERY COVER

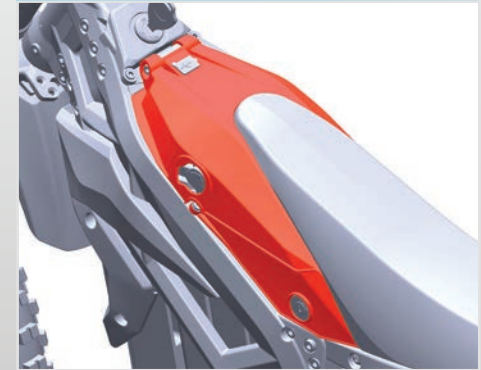

! Please make sure that the key switch is OFF before removing battery

# STAGE2

ADULT OFF-ROAD ELECTRIC DIRT BIKE

## BATTERY INSTALLATION / REMOVAL

### STEP 5: FLIP FUSE SWITCH ON / OFF

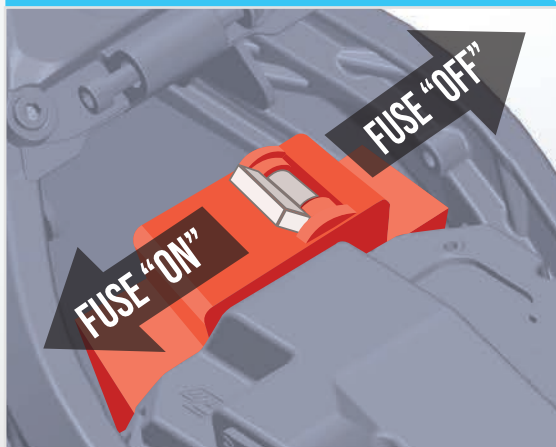

### STEP 7: REMOVE POWER CONNECTOR

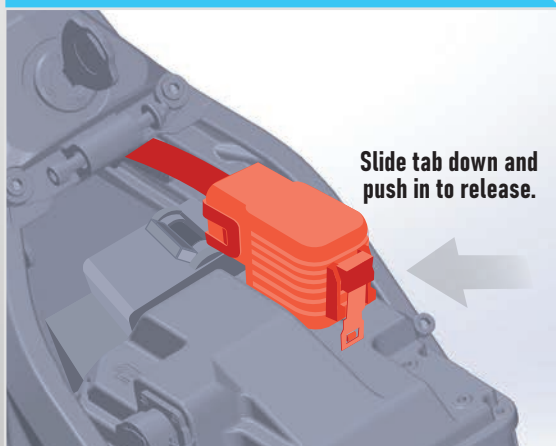

### STEP 6: REMOVE BATTERY

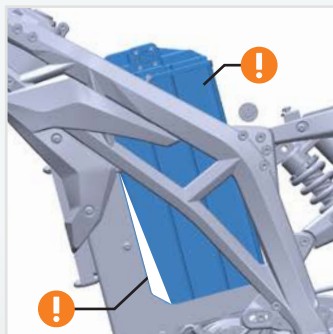

When reinstalling the battery, make sure battery is seated properly, if not the seat and cover will not close!

! Please make sure that the key switch is OFF before removing battery

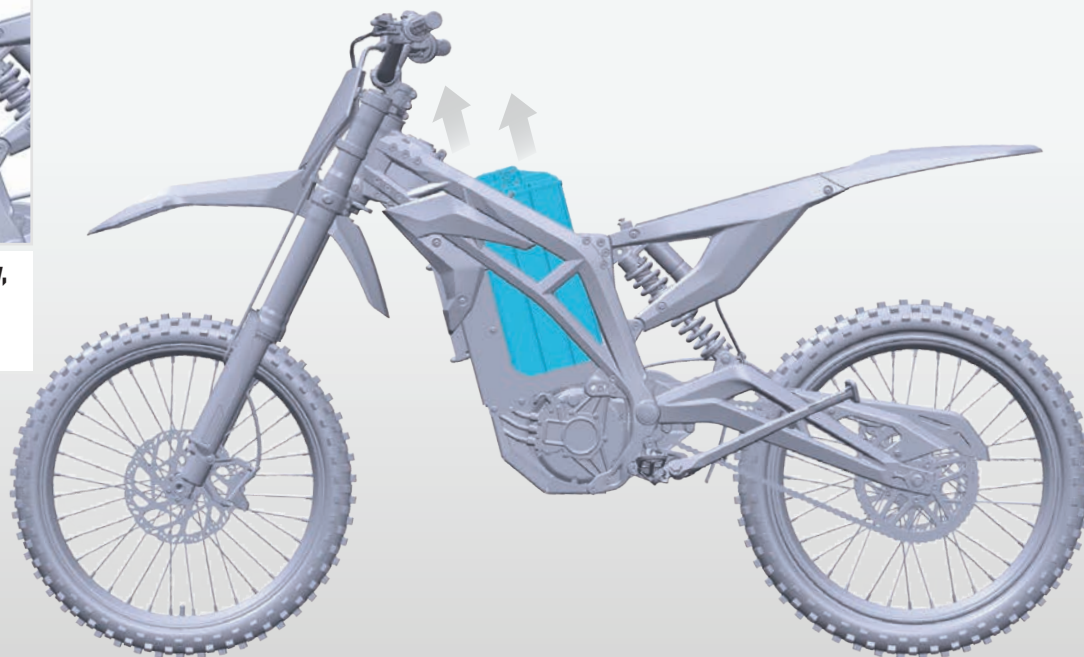

### ⚠ WARNING

Changes or modifications to this unit not expressly approved by Stage2 / Razor USA will void the warranty.

### ⚠ WARNING

Set the fuse switch to "OFF" before removing/installing the battery. Leaving the fuse switch set to "ON" can cause sparks.



# BATTERY CHARGING

Charger / Charging Cable



Charging Port and Cover (installed)

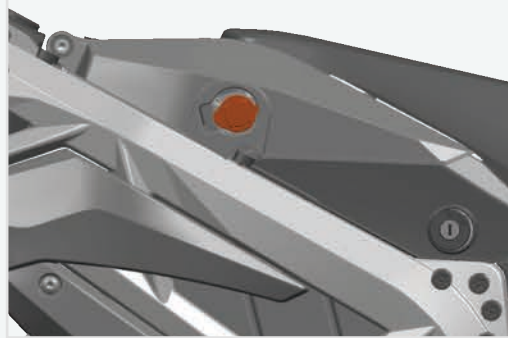

## HOW TO CHARGE THE BATTERY

1. Please make sure the charger is firmly connected to the battery charge port, located on the left side.
2. Check to make sure charger is plugged into wall outlet or power supply.
3. The charger will be turned off automatically after the battery is fully charged. (estimated charge time 4 hours)

### Light Indications on the Charger

- Solid green means battery is fully charged.
- Flashing green is idle standby not plugged in.
- Solid red light means the battery is charging.

Charging Port  
and Port Cover  
(removed)



### NOTE:

- To remove battery and charge it outside of the bike, see pages 13 and 14 for battery removal procedure.
- Unplug the charger from outlet when the charger is not in use.
- If the charger gets warm during regular use, this is a normal response and is no cause for concern. If your charger does not get warm during use, it does not mean that it is not working properly.

## ⚠ WARNING

Please make sure to use the supplied manufacturer's lithium-ion battery charger. Turn off the circuit switch before installing or removing the battery from the bike. It is risky to connect the power cable while the circuit switch is on, it might cause spark and damaged the plug, it may even damage the battery. The charger will be automatically turned off when the battery is fully charged, however, please avoid leaving the charger connected to the power supply for too long.

## CHARGING SAFETY

- When charging, keep the battery in a safe place where children can't reach.
- NEVER cover the charger when charging. This charger is for indoor use, please make sure to use it in a dry, well-ventilated environment.
- NEVER store the charger outdoors - always store indoors when not in use.
- NEVER set the output cable, power cord and the charger on a wet surface.
- NEVER use the charger with defective power cord and damage wires.
- NEVER attempt to plug in the charger using wet hands or in an extremely humid environment.
- NEVER place the charger directly under the sun.
- NEVER use the charger in inflammable and explosive areas.
- NEVER cover the vent on the charger and keep the vent 10cm away from other objects. NEVER disassemble, repair and modify the charger.
- ALWAYS unplug charger from AC outlet before attempting any maintenance or cleaning.
- ALWAYS place the charger in a clean and ventilated environment while charging.
- ALWAYS plug in and unplug the AC power cord by grasping the plug and
- DO NOT DRAG THE POWER CORD ITSELF to reduce risk of damaging power cord.

## LIMITED WARRANTY

We guarantee that every charger has been tested before shipping. Please contact customer support immediately, if there are any damages to the charger. Following the shipping date, we offer a 90 day warranty. This warranty applies to the CHARGER ONLY.

The warranty is void if:

- Warranty period has expired.
- No receipt or invoice.
- The damage is caused by improper operation.
- The owner does not follow this instruction.
- The damages are caused by force majeure.

## ⚠ WARNING

Battery charge can deplete over time. Periodically recharge battery when not in use.

# STAGE 2

ADULT OFF-ROAD ELECTRIC DIRT BIKE

## BATTERY SAFETY

### Battery Capacity Protection

When the battery capacity falls below 15%, the controller will automatically reduce power output and maximum current limit to avoid sudden battery cutoff.

**Please note the drive mode will not change when the battery percentage falls below 15%.**

### Low Voltage Protection

The controller has a low-voltage protection function for battery discharge. When the battery voltage reaches the low-voltage protection value (48 V), the controller cuts off the output and the bike will no longer run.

### Controller Overheating

If the controller's working temperature surpasses 100°C (212°F), the bike will automatically reduce power. Continual overheating beyond 100°C (212°F) will result in a complete output cutoff.

### Motor Overheating

When the motor's temperature exceeds 140°C (284°F), the bike will reduce power and enter EP mode. Overheating beyond 140°C (284°F) will result in an output cutoff.

### Working Conditions

In temperatures below 0°C (32°F), the battery may operate at 80% of its normal capacity. Riding in SPORT mode is not recommended under these conditions. In temperatures exceeding 40°C (104°F), it's advisable not to use full power for extended periods.

### Riding in Water

The Stage 2 motorcycle's electrical components have basic waterproofing protection. Extended submersion, particularly when the motor is hot may cause damage.

### Battery Protection

Damaged or used batteries should not be dismantled. Batteries should be recycled through call2recycle or designated recycling center. Avoid discarding the battery in any other way.

If the bike is not used for over a month, turn off the fuse switch or remove the power connector. Make sure the battery is fully charged before storing. When not charging, ensure the battery compartment cap on the charging port is closed securely.

### Ingress Protection (IP) Levels

**Battery:** IP65

**Motor:** IP67

**Controller:** IP67

**Connector:** IP65

Connect the charger to the charging port and ensure it's connected to the appropriate power supply.

### ⚠ WARNING

Do not charge the battery below 0°C (32°F) to prevent damage.  
Wait until the temperature is suitable for charging.

### ⚠ WARNING

Risk of Fire and Electric shock - No user Serviceable Parts.





### Key/Ignition

Check to make sure the key is fully inserted into the key hole just in front of the seat. Insert key and turn clockwise to turn the bike on.



### Display

Hold the "M" button on the display for 3 seconds to turn on the display functions. Cycle through the modes to make sure you are in the correct settings for your ride.



### Brakes

Check the brakes for proper function. When you squeeze the brake levers (on handlebar) the brakes should provide positive braking action. When you apply the brakes with the throttle on/engaged, the brake cut-off switch should cut power to the motor.



### Battery

Make sure the battery is properly installed before attempting riding, see pages 8 and 9 of this manual for information on proper battery installation and removal.



### Wheels

Periodically inspect the wheels for excessive wear and or damage.



### Tires

Periodically inspect the tires for excess wear and replace as needed. Regularly check the tire pressure and inflate as needed.



Following this checklist will help to prevent injury to the rider and possible damage to the electric dirt bike



### Frame, Fork and Handlebars

Check for cracks or broken connections. Although broken frames are rare, it is possible for an aggressive rider to run into an object and crash, bend or break a frame. Get in the habit of inspecting your Stage2 on a regular basis.



### Hardware/Loose Parts

Before every ride, check all parts, such as nuts, bolts, fasteners, etc., to ensure they are secure and assembled correctly. There should not be any unusual rattles or sounds from loose parts or broken components. If the product is damaged, do not ride. Reference "Safety Warnings" on pages 4 and 5 of this manual.



### Safety Gear

Always wear proper protective equipment, such as an approved safety helmet (with chin strap securely buckled), elbow pads, and kneepads. A helmet may be legally required by local law or regulation in your area. A long-sleeved shirt and long pants are recommended. Always wear shoes and keep shoelaces tied and out of the way of the wheels and drive system. NEVER RIDE BAREFOOTED OR IN SANDALS.



### Laws and Regulations

Always check and obey any local laws or regulations.



### Insurance

Do not assume that your existing insurance policies necessarily provide coverage for electric product use. Check with your insurance company for information regarding insurance.



### Storage

Prolonged exposure to UV rays, rain and the elements may damage the enclosure materials, store indoors when not in use.

# STAGE2

ADULT OFF-ROAD ELECTRIC DIRT BIKE

## RIDING PROCEDURES

**!** Acceleration must be done smoothly and gently. Improper operation will cause damage to bike parts, or even accidents. The manufacturer suggests keeping bike in "L" low mode for first time riding, and moving to higher modes "D" & "S" when you are fully familiar with the bike.

**Step 1: Insert the key into on/off slot, turn clockwise.**

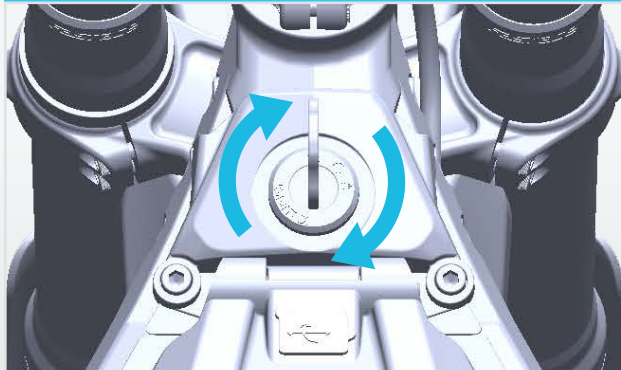

- First position turns the bike ON
- Second position keeps the bike ON + Accessory Mode

**Step 2: Press "S" to choose from 3 drive modes**

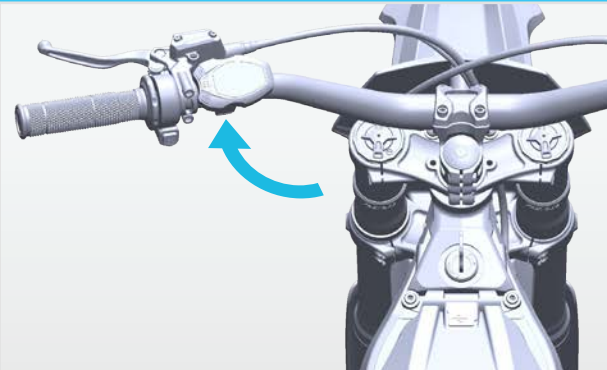

**NOTE:** Bike will power on in Park mode.

**Step 3: Once ready to ride, release the kickstand.**

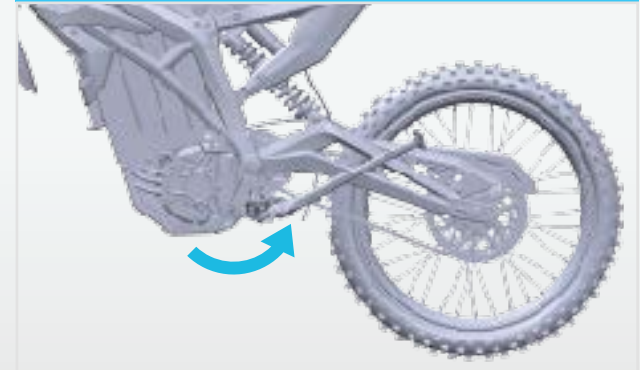

**!** Bike will remain in "E3" (kickstand sensor activated) when the kickstand is down.

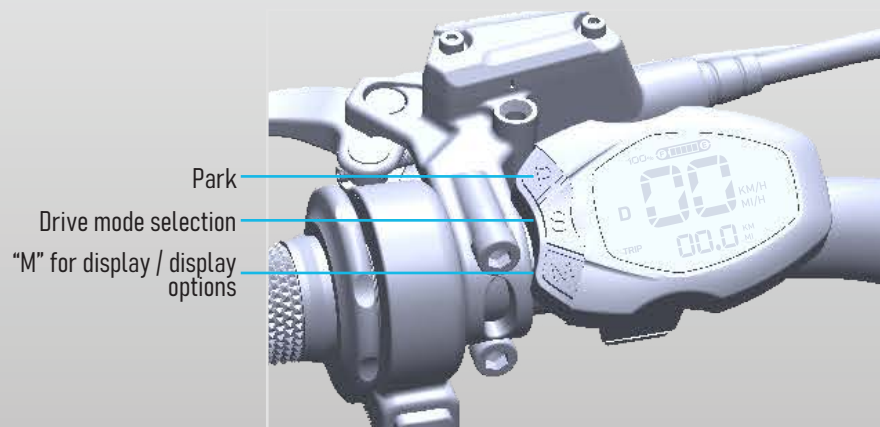

### HOW TO RIDE / OPERATE

Complete the following after steps 1-3 above.

1. Sit on the Stage2 with both feet on the ground on either side of the frame to balance the product.
2. Place both hands on the handlebars.
3. Select speed / display mode. See page 14 for instructions.
4. The Stage2 default mode is the "D" mode. To activate the other drive modes see page 14.
5. Twist the throttle with your right hand. Place feet on foot pegs once in motion.
6. Note: Keep both feet on the foot pegs while the Stage2 is in motion.
7. To stop, release the throttle and apply the brakes, by squeezing the brake levers, until the product comes to a complete stop. When coming to a complete stop, place both feet on the ground to balance.
8. Make sure to turn the product OFF after your ride is complete.

# STAGE 2

ADULT OFF-ROAD ELECTRIC DIRT BIKE

## DISPLAY FUNCTIONS

**!** Acceleration must be done smoothly and gently. Improper operation will cause damage to bike parts, or even accidents. Suggest keeping bike in "L" low mode for first time riding, and moving to higher modes "D" & "S" when you are fully familiar with the bike.

### DISPLAY FUNCTIONS



#### STEP 1:

After turning key to the "ON" position, the display will automatically turn on, revealing the speedometer, battery indicator, drive modes, and display modes



#### STEP 2:

Bottom display has 6 options, to cycle between these modes, press the "M" button.



#### STEP 3:

To select drive modes, press the "S" button. This will cycle through the 3 drive modes. Pressing "P" activate the park mode, which will keep the bike from driving.



#### STEP 4:

To select between kilometers and miles, hold the "P" button for about 3 seconds and release

NOTE: Bike will automatically be in "P" Park once turned on

#### ① CURRENT TRIP DISTANCE

TRIP 00.0 KM MI

#### ② TOTAL ODOMETER

ODO 0000 KM MI

#### ③ DIGITAL CLOCK

00:00 TIME

#### ④ VOLT METER

60.0 V

#### ⑤ DISCHARGE CURRENT

00 A

#### ⑥ MOTOR TEMPERATURE

00 C (M)

00 F (M)

### DRIVE MODES

**P** - Park  
**L** - Low  
**D** - Drive  
**S** - Sport

### SPEED

27 mph / 43.4 km/h  
37 mph / 59.5 km/h  
47 mph / 75.6 km/h

**!** In the event a display is damaged to the point the readouts are no longer visible, emergency restart mode will need to be activated. See page 16 of troubleshooting guide for activation procedure.



### Error codes are identified by the sound of the controller buzzer

- The buzzer will sound once when you turn on the product.
- If the buzzer sound persists for a long period of time, please check to make sure the brake and throttle are not being activated. The buzzer will continue to sound if both the throttle and brake are activated at the same time at start-up.

| ERROR TYPE                        | BUZZER SOUNDS | ERROR DESCRIPTION                                                               | HOW TO TROUBLESHOOT                                                                                                                                                                                                                                        |
|-----------------------------------|---------------|---------------------------------------------------------------------------------|------------------------------------------------------------------------------------------------------------------------------------------------------------------------------------------------------------------------------------------------------------|
| Motor hall fault                  | 1             | The signal line between the controller and the motor is not connected properly. | Check the connection between the motor wire and controller hall sensor wire. Reconnect wires if they aren't connected. If the connections are good, there is a high possibility the motor needs to be replaced.                                            |
| Throttle fault                    | 2             | Throttle is either broken or not in zero position (Not being twisted).          | Check to see if the throttle is in the zero position and check for visible damage. If throttle is in zero position and there is no damage, check the wire connection. If the wire connection is good, the motor or the controller may need to be replaced. |
| Current protected restart         | 3             | Fault protection warning.                                                       | Restart the bike. If the fault persists, replace the controller.                                                                                                                                                                                           |
| Phase current over current        | 4             | Fault protection warning.                                                       | Restart the bike. If the fault persists, replace the controller.                                                                                                                                                                                           |
| Voltage fault                     | 5             | Voltage is too low or too high. Beyond the controller allowed range.            | Charge the battery or replace with a fully charged battery. If the fault persists, replace the controller.                                                                                                                                                 |
| N/A                               | 6             | N/A                                                                             | N/A                                                                                                                                                                                                                                                        |
| Motor temperature protection      | 7             | Motor temperature is too low or too high. Beyond the allowed range.             | Turn off the bike and try riding again after the motor returns to room temperature. If the fault still exists, there is a high possibility of replacing the controller. There is a low possibility of needing to replace the motor.                        |
| Controller temperature protection | 8             | Controller temperature is too low or too high. Beyond the allowed range.        | Turn off the bike and try riding again after the controller temperature cools down. If the fault still persists, replace the controller.                                                                                                                   |
| Phase current overflow            | 9             | Fault protection warning.                                                       | Restart the bike. If the fault persists, replace the controller.                                                                                                                                                                                           |
| Phase current zero fault          | 10            | Controller warning.                                                             | Restart the bike. If the fault persists, replace the controller.                                                                                                                                                                                           |
| Phase line short-circuit fault    | 11            | Phase line short-circuit or motor issue.                                        | Check whether there is a short-circuit in the motor phase line. If there is no abnormality, there is a high possibility of replacing the controller. There is a low possibility of needing to replace the motor.                                           |
| Line current zero fault           | 12            | Controller warning.                                                             | Restart the bike. If the fault persists, replace the controller.                                                                                                                                                                                           |
| MOSFET (top one) issue            | 13            | Controller broken.                                                              | Check if the motor phase line and controller connection is good. If connection is ok, replace the controller.                                                                                                                                              |
| MOSFET (bottom one) issue         | 14            | Controller broken.                                                              | Check if the motor phase line and controller connection is good. If connection is ok, replace the controller.                                                                                                                                              |
| Peak line current protection      | 15            | Hardware over current protection warning.                                       | Restart the bike. If the fault persists, replace the controller.                                                                                                                                                                                           |

! If issues with your bike continue, please contact Razor USA / Stage2 customer service (866) 467-2967

# STAGE 2

ADULT OFF-ROAD ELECTRIC DIRT BIKE

## ADDITIONAL TROUBLESHOOTING TIPS

| DESCRIPTION                                        | HOW TO TROUBLESHOOT                                                                                                                                                                                                                                                                                                                                                         |
|----------------------------------------------------|-----------------------------------------------------------------------------------------------------------------------------------------------------------------------------------------------------------------------------------------------------------------------------------------------------------------------------------------------------------------------------|
| <b>Kickstand down.</b>                             | Kickstand has a sensor that prevents the bike from driving when it is down. When the kickstand is down, the “P” park mode is automatically activated. Put the kickstand in the up position and try riding procedure again.                                                                                                                                                  |
| <b>Fuse switch in the “OFF” position.</b>          | The fuse switch located inside the battery box needs to be in the “ON” position. If the fuse is in the “OFF” position, there will be no power from the battery and the bike won’t be able to drive.                                                                                                                                                                         |
| <b>Throttle is not in zero position.</b>           | Check to make sure the throttle is rotated into its “Zero or Start” position. If throttle is partially activated the bike will power on, but will not run.                                                                                                                                                                                                                  |
| <b>Battery not charged.</b>                        | Check to make sure the battery is fully charged, charge the battery and try riding again. If battery is unable to hold a charge, then a replacement battery will be needed.                                                                                                                                                                                                 |
| <b>Verify brake levers are not engaged.</b>        | Check to make sure the brake levers are in their “Zero or Start” position. If brake levers are partially activated the bike will turn on, but will not run.                                                                                                                                                                                                                 |
| <b>Orientation sensor is activated.</b>            | If the bike is laying down on its side or parked on an uneven surface, the built in tilt sensor will be activated and the bike will turn on, but will not run. Move the bike to level ground and try riding procedure again.                                                                                                                                                |
| <b>Key Ignition Accessory Mode</b>                 | When activating accessories for the bike, the ignition key needs to be turned two full clicks clockwise to activate accessory mode, such as the light.                                                                                                                                                                                                                      |
| <b>Damage to display-<br/>Emergency start mode</b> | If the digital display is damaged and cannot be read, the emergency restart mode will need to be activated. To activate the emergency mode, start with the kickstand down, and cycle the kickstand Up, Down, Up. This will allow the bike to ride in “L” mode with limited functionality. The display will need to be replaced in order to restore full bike functionality. |
| <b>E1 code displayed</b>                           | When E1 is displayed, it indicates a motor hall failure. Check for loose connections, disconnected, or pinched wires. After troubleshooting, motor may need to be replaced.                                                                                                                                                                                                 |
| <b>E3 code displayed</b>                           | When E3 is displayed, a sensor such as the orientation, kickstand, or brake cut off is being triggered. Power is restricted until the sensors are no longer activated.                                                                                                                                                                                                      |
| <b>E4 code displayed</b>                           | When E4 is displayed, it indicates controller failure. Check for loose connection, disconnected, or pinched wires. After troubleshooting, controller may need to be replaced.                                                                                                                                                                                               |
| <b>E5 code displayed</b>                           | When E5 is displayed, it indicates that the throttle is damaged. Check for loose connection, disconnected, or pinched wires. After troubleshooting, throttle may need to be replaced.                                                                                                                                                                                       |

! If issues with your bike continue, please contact Razor USA / Stage2 customer service (866) 467-2967



## MAINTENANCE GUIDE

Turn power switch "OFF" before beginning any repair or maintenance.

- Read the instructions.
- Remove the charger plug.
- Turn the power off.
- Secure the product under repair.
- Exercise caution around exposed parts.
- Contact Razor USA / Stage2 customer service if unsure about and repair or maintenance.
- Repair and maintenance should be performed by an adult only.

## CHECK PARTS

- Check all critical parts for damage, missing components or loose connections.
- Re-inspect the parts that were not installed from the factory.
- Check the chain tension.
- Check the display functions to make sure all important information and functions are working.
- Suspension adjustment. Check if there is oil leakage and if the compression and rebound damping is in the correct position.
- Check the tightness of all screws on the handlebars.

**Note:** Bike should be inspected in a safe environment. It is recommended that you park the bike on flat ground for inspection. When inspection is needed, please consult the manual or customer service for detailed instructions. If there is any issue during the inspection, DO NOT ride without resolving the issue. If the issue continues or is too difficult for you to solve, please contact customer service.

## CHARGER

The charger supplied with this product should be regularly examined for damage to the cord, plug, enclosure and other parts and in the event of such damage, the product must not be charged until it has been repaired or replaced.

Use **ONLY** with the recommended charger.

**Not intended for use at elevations greater than 2000 m above sea level.**

## CHECK OPERATION

1. Inspect for bent, deformed, or damaged parts.
2. Engage front brake and press down on the handlebars to check that the front fork is functioning properly. If the fork is damaged or malfunctioning, please contact customer service.
3. Check Brakes. Activate the front and rear brake lever to see if the calipers are squeezing the rotor. DO NOT ride if one or both brakes are not operational. If the brakes are operational, ride at low speed on dry flat surface for inspection.
4. Check Tires. The tires can and will be damaged by debris such as glass, metal, stones and other matter on the ground. Check tire pressure before riding, if tire pressure is low, refill to the recommended PSI listed on the sidewall of tire. Please pay attention to the conditions when riding. Avoid riding in places where tires may be damaged. In addition, you should often check if the tires have distinct defects such as cracks, cuts and other damages. Tire should be replaced if there is significant damage, low groove depth, discoloration, if the tire is more than 5 years old.

For any questions or concerns regarding maintenance on the product, please contact Razor USA / Stage2 Customer Service at: (866) 467-2967

## REPLACEMENT PARTS

The most frequently requested replacement parts are available for purchase at some Razor retail partners. For the complete selection of replacement parts visit [www.Stage2moto.com](http://www.Stage2moto.com)

## REPAIR CENTERS

For a list of authorized Razor repair centers check online at [www.Stage2moto.com](http://www.Stage2moto.com)

### ⚠ WARNING

The front and rear brakes are disc brakes, when the brake pads are worn please replace them as soon as possible. To avoid injury or damage, keep the disc brake system clean. Avoid long-term adhesion of sediment and oil pollution, these will prevent proper stopping power of the brakes.

### ⚠ WARNING

During the maintenance process, DO NOT power on the bike. This can cause injury or damage.



# STAGE2

ADULT OFF-ROAD ELECTRIC DIRT BIKE

## MAINTENANCE

### CLEANING YOUR STAGE2

Turn power switch "OFF" before beginning any repair or maintenance.

Wipe with a damp cloth to remove dirt and dust. Do not use industrial cleaners or solvents as they may damage the surfaces. Do not use alcohol, alcohol-based or ammonia-based cleaners as they may damage or dissolve the plastic components or soften the decals or decal adhesive.

### BATTERY CARE AND DISPOSAL

Do not store in freezing or below freezing temperatures. To properly maintain your battery and ensure maximum battery life, carefully read the "Charging the Battery" section on page 10 of this owner's manual.

**Disposal:** Your electric product uses a lithium-ion battery pack which must be recycled or disposed of in an environmentally safe manner. Do not dispose of a battery pack in a fire. The battery pack may explode. Do not dispose of a battery pack in your regular household trash. The incineration, land filling or mixing of batteries with household trash is prohibited by law in most areas. Return exhausted batteries to a federal or state approved lithium-ion battery recycler.



CONTAINS LITHIUM-ION BATTERY PACK.  
BATTERIES MUST BE RECYCLED.

### RECYCLING LITHIUM-ION BATTERIES

Lithium-ion batteries are recyclable. You can help preserve our environment by returning your used rechargeable batteries to the collection and recycling location nearest you.

### RECYCLING IN THE US AND CANADA ONLY

Lithium-ion batteries are recyclable. You can help preserve our environment by returning your used rechargeable batteries to the collection and recycling location nearest you.

For more information regarding recycling of rechargeable batteries, call toll free 1-800-822-8837, or visit <http://www.call2recycle.org>



For any questions or concerns regarding maintenance on the product, please contact **Razor USA / Stage2 Customer Service at: (866) 467-2967**

#### ⚠ WARNING

Using a hose or pressure washer on this product can damage wire connections and waterproof areas.

#### ⚠ WARNING

DO NOT handle damaged lithium-ion batteries.

# STAGE 2

ADULT OFF-ROAD ELECTRIC DIRT BIKE

## PRODUCT SPECIFICATIONS

### BIKE SPECIFICATIONS

|                   |                                                               |
|-------------------|---------------------------------------------------------------|
| MOTOR             | BRUSHLESS DC PERMANENT MAGNET MOTOR                           |
| PEAK POWER        | 6 KW                                                          |
| REAR WHEEL TORQUE | 260 N.M                                                       |
| CONTROLLER        | 60 V 100 A EFFICIENT ADAPTION                                 |
| BATTERY           | UL 2271 COMPLIANT -60 V 35 AH (SAMSUNG 21700 CELL). REMOVABLE |
| FRAME             | FORGED ALUMINUM ALLOY                                         |
| MAX SPEED         | > = 47 MPH / 75.6 KM/H                                        |
| RANGE             | > = AVERAGE 40 MILES / 64 KILOMETERS                          |
| CHARGE TIME       | 4 HOURS                                                       |
| FRONT WHEEL       | 7 SERIES ALLOY RIM 1.4-19", TIRE 70/100-19"                   |
| REAR WHEEL        | 7 SERIES ALLOY RIM 1.6-18", TIRE 80/100-18"                   |
| FRONT FORK        | FAST ACE INVERTED FRONT FORK FULLY ADJUSTABLE                 |
| REAR SHOCK        | FAST ACE ADJUSTABLE SHOCK ABSORBER                            |
| BRAKE             | FRONT AND REAR HYDRAULIC DISC BRAKES 8" / 203 MM              |
| HANDLEBAR         | ALUMINUM TAPERED BAR, WIDTH: 30" / 760 MM                     |
| MODES             | PARK, SPORT, DRIVE, LOW                                       |

### DIMENSIONS

|                          |                                        |
|--------------------------|----------------------------------------|
| SEAT HEIGHT              | 33 ± 0.2" / 850 ± 5 MM                 |
| WHEEL BASE               | 50 ± 0.2" / 1285 MM ± 5 MM             |
| MAX LOAD (TESTED WEIGHT) | 200 LB / 90 KG                         |
| GROUND CLEARANCE         | 11" / 285 MM                           |
| PRODUCT WEIGHT           | 143 LB / 65 KG                         |
| PACKOUT WEIGHT           | 173 LB / 78 KG                         |
| PRODUCT DIMENSIONS       | 75" X 30" X 44" / 1900 X 750 X 1100 MM |
| PRODUCT PACKAGE SIZE     | 66" X 13" X 34" / 1680 X 330 X 830 MM  |



Speed 47 mph



Battery 60V 35Ah



Range 40 Miles



Charge time 4 hours



Max weight 200 lb



# STAGE 2

ADULT OFF-ROAD ELECTRIC DIRT BIKE

## PRODUCT SPECIFICATIONS

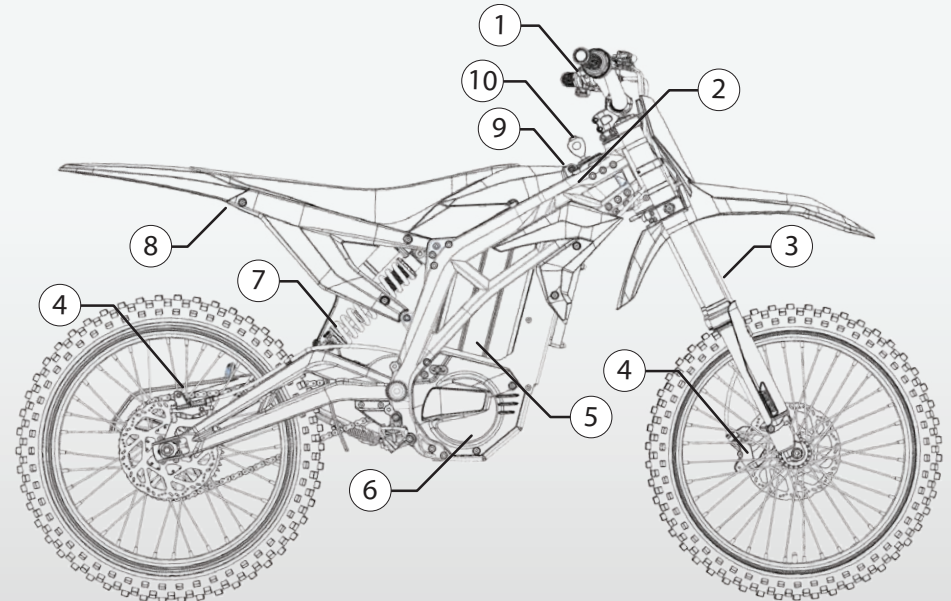

### PRODUCT DIAGRAM

|    |                                |     |                                           |
|----|--------------------------------|-----|-------------------------------------------|
| 1. | DIGITAL DISPLAY                | 6.  | 6 KW MOTOR                                |
| 2. | CAST ALUMINUM FRAME            | 7.  | FAST ACE REAR SHOCK                       |
| 3. | FAST ACE FRONT SUSPENSION FORK | 8.  | REAR SEAT RELEASE (FOR REMOVING BATTERY)  |
| 4. | HYDRAULIC DISC BRAKES          | 9.  | USB ACCESSORY PORT                        |
| 5. | UL COMPLIANT 60 V BATTERY      | 10. | ON/OFF KEYED POWER SWITCH, ACCESSORY MODE |



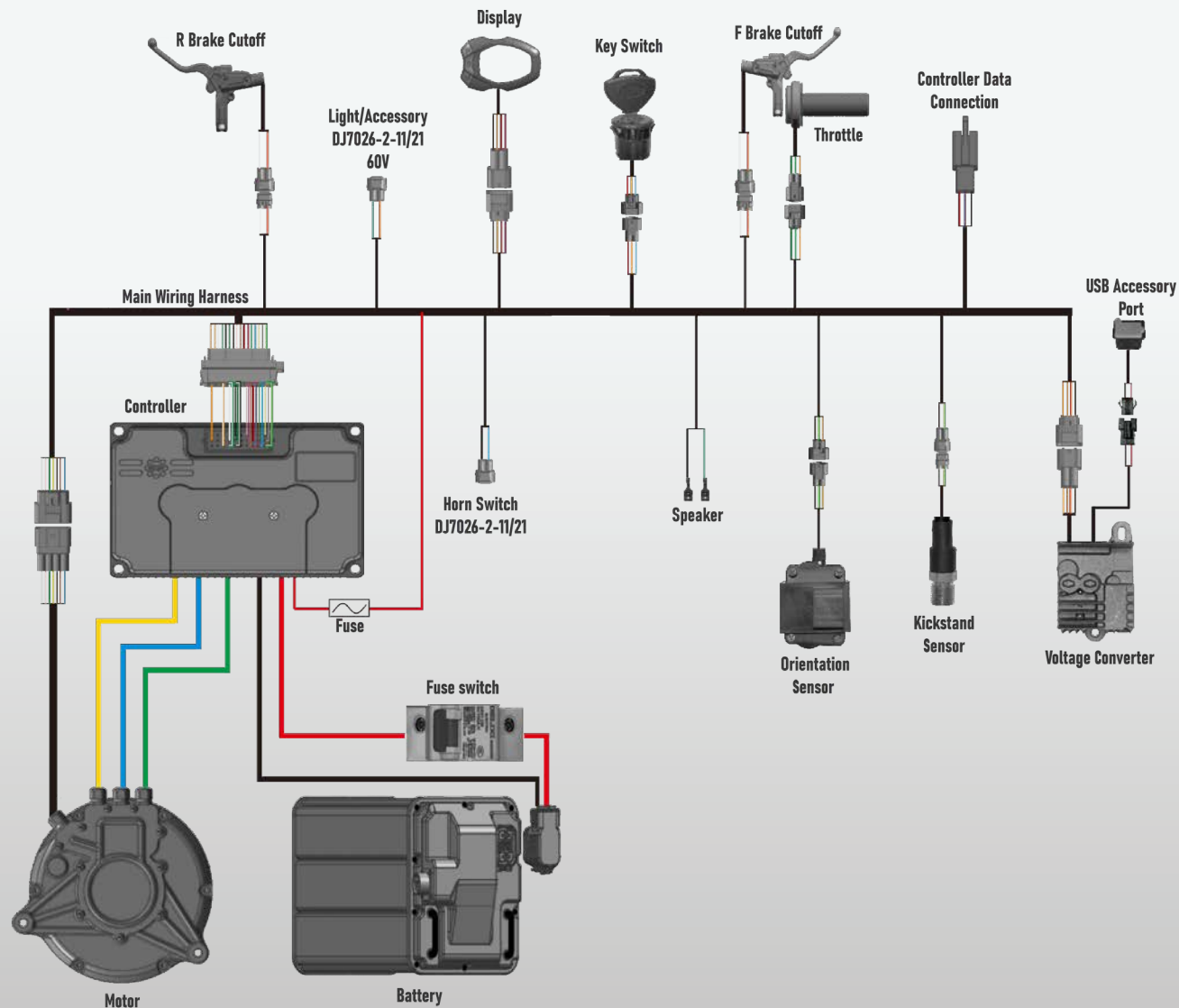

### STAGE2 LIMITED WARRANTY

The manufacturer warrants this product to be free of manufacturing defects for a period of 90 days from date of purchase. This Limited Warranty does not cover normal wear and tear, tire, tube or cables, or any damage, failure or loss caused by improper assembly, maintenance, storage or use of the Stage2 electric dirt bike.

**This Limited Warranty will be void if the product is ever:**

- Used in a manner other than for recreation;
- Modified in any way;
- Rented, or loaned.

The Stage2/Razor is not liable for incidental or consequential loss or damage due directly or indirectly to the use of this product.

Stage2/Razor does not offer an extended warranty. If you have purchased an extended warranty, it must be honored by the store at which it was purchased.

For your records, save your original sales receipt with this manual and write the serial number here. \_\_\_\_\_

### NOTICE: INSURANCE

**YOUR INSURANCE POLICIES MAY NOT PROVIDE COVERAGE FOR ACCIDENTS INVOLVING THE USE OF THIS SCOOTER/ELECTRIC RIDE-ON PRODUCT.  
TO DETERMINE IF COVERAGE IS PROVIDED, YOU SHOULD CONTACT YOUR INSURANCE COMPANY OR AGENT.**

This device complies with Part 15 of the FCC Rules. Operation is subject to the following two conditions: (1) This device may not cause harmful interference, and (2) this device must accept any interference received, including interference that may cause undesired operation.

**Note:** This equipment has been tested and found to comply with the limits for a Class B digital device, pursuant to part 15 of the FCC Rules. These limits are designed to provide reasonable protection against harmful interference in a residential installation. This equipment generates, uses and can radiate radio frequency energy and, if not installed and used in accordance with the instructions, may cause harmful interference to radio communications. However, there is no guarantee that interference will not occur in a particular installation. If this equipment does cause harmful interference to radio or television reception, which can be determined by turning the equipment off and on, the user is encouraged to try to correct the interference by one or more of the following measures:

- Reorient or relocate the receiving antenna.
- Increase the separation between the equipment and receiver.
- Connect the equipment into an outlet on a circuit different from that to which the receiver is connected.
- Consult the dealer or an experienced radio/TV technician for help.



ADULT OFF-ROAD ELECTRIC DIRT BIKE

# CUSTOMER SERVICE CONTACT INFORMATION

Need Help? Visit our website for product support, a list of authorized service centers in the US and customer service contact information at [www.Stage2moto.com](http://www.Stage2moto.com) or [www.razor.com](http://www.razor.com). Please have the product I.D. code (located on the white label of your product) available for better assistance. Additional Customer Service contact information is listed below:

Distributed by Razor USA LLC  
P.O. Box 3610  
Cerritos, CA 90703  
USA  
+1 866 467 2967  
Monday - Friday  
8:00 AM - 5:00 PM Pacific Time  
[customersupport@razorusa.com](mailto:customersupport@razorusa.com)

Printed in China for Razor USA LLC.

Copyright ©2024 Razor USA LLC. All rights reserved. Razor® and the Razor logo design are among the registered trademarks of Razor USA LLC and/or its affiliated companies in the United States and/or select foreign countries. Stage2, S2 and the logo designs are trademarks of Razor USA LLC.

US\_240723

